

2X C-BORE HOLES FOR
#8 OR M4 CAP SCREWS

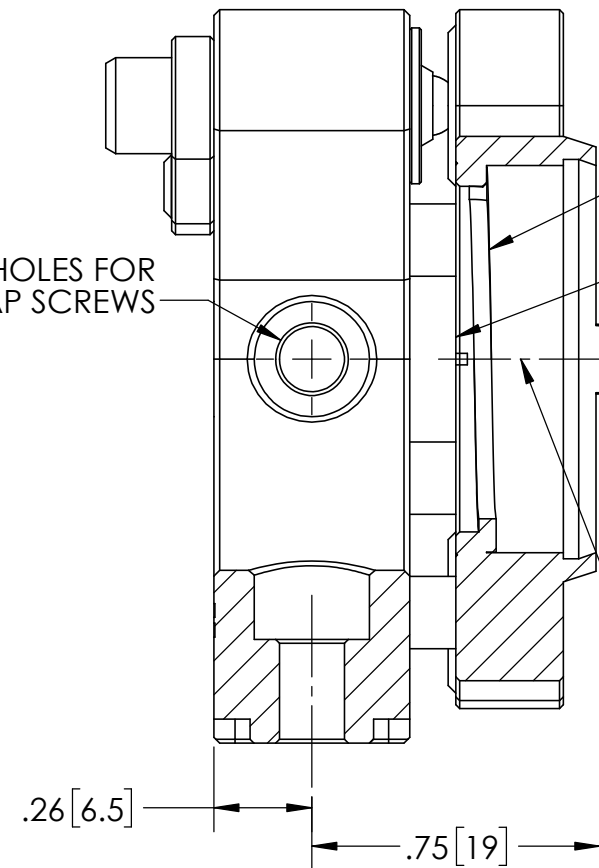

PTFE BACKUP RING
FOR SOFT CONTACT

SM1 RETAINING RING
(1.035-40 THREAD)

OPTICS POCKET
HOLDS MAX .25[6.35]
THICKNESS OPTICS

$\phi .83 [21.1] CA$

1.00 [25.4]

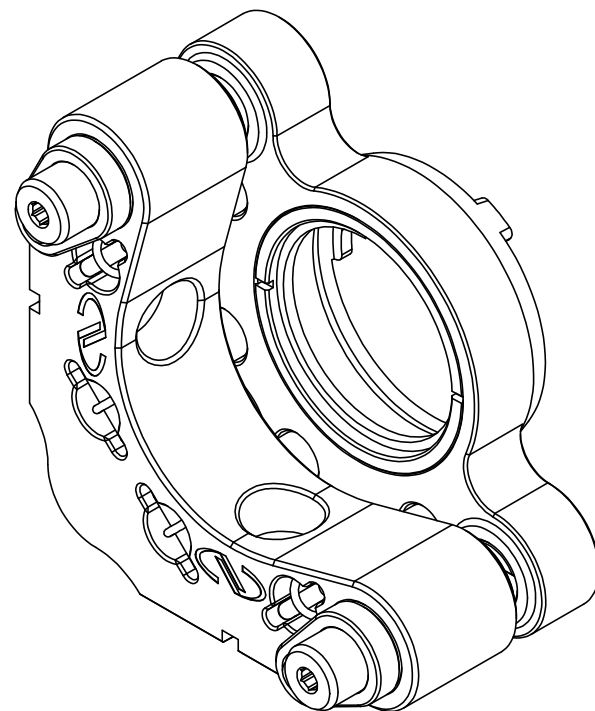
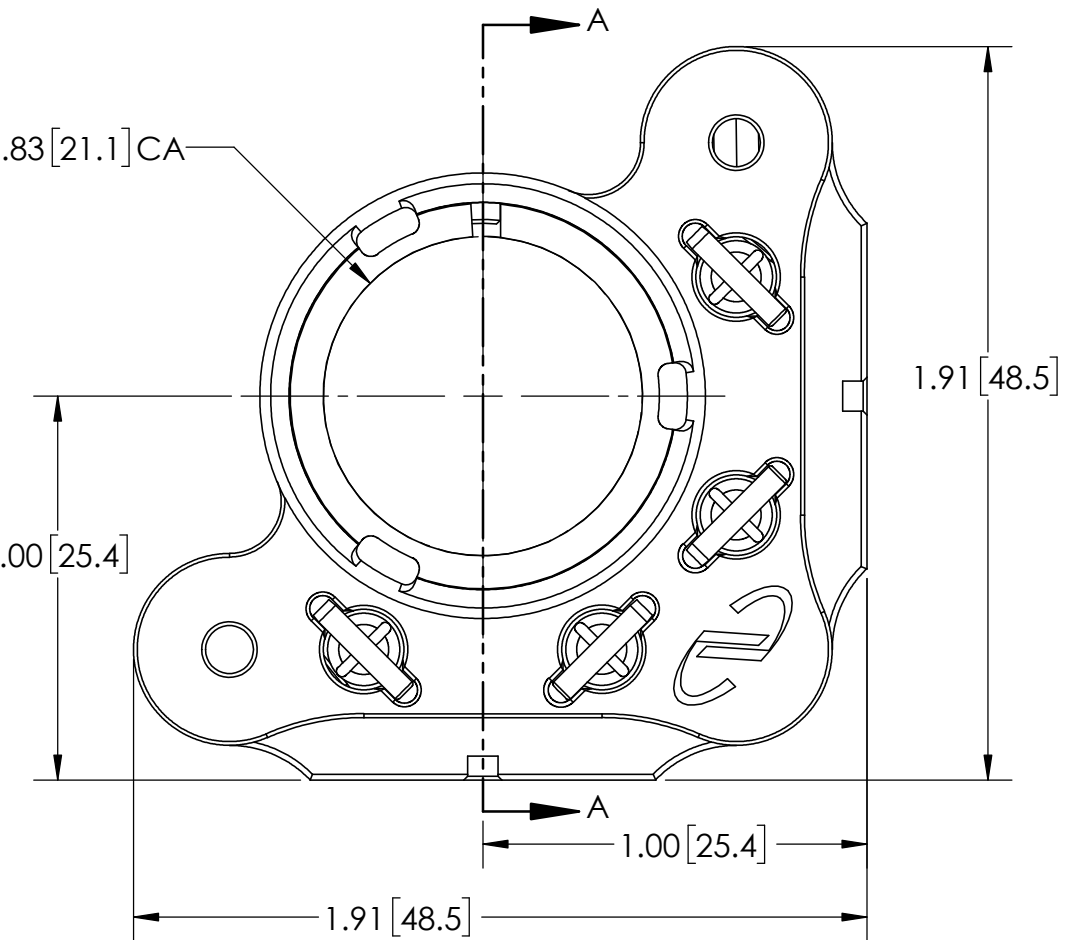

MODEL ST100T-R2H
REAR LOAD, 2 HEX ADJUSTORS

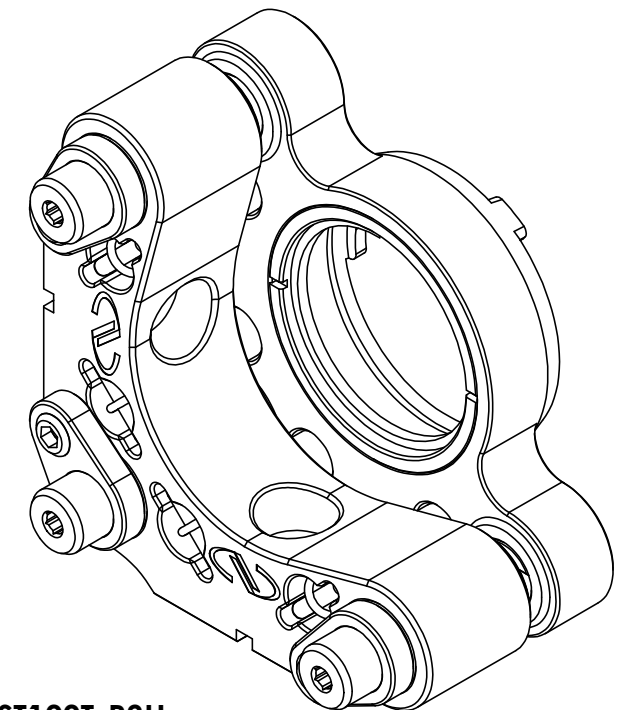
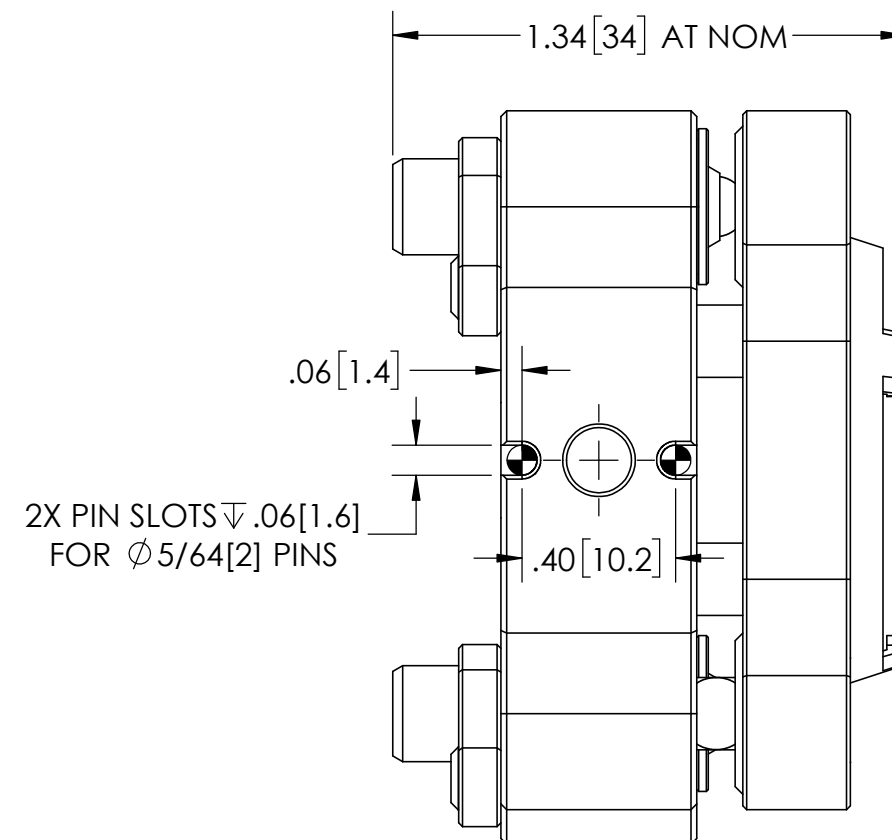

MODEL ST100T-R3H
REAR LOAD, 3 HEX ADJUSTORS